



Refrigeration
and
deep-freezing

Compressor cooling

Powerful and durable

Even at extreme outside temperatures

Excellent cooling performance regardless of the ambient temperature, versatile use – these are the distinguishing features of a compressor cooler.

Covering a temperature range from +10°C to -18°C, compressor coolers by WAECO are as powerful as a domestic fridge. The difference is they can be used absolutely everywhere: on yachts and boats, in cars and motorhomes, at home, in holiday apartments – wherever you want.

Most powerful and most durable cooling in mobile and stationary use

Excellent cooling performance even at extreme ambient temperatures

Deep-freezing functionality

Energy saving and superbly quiet operation

Impeccable operation in inclined position

Suitable for operation with a solar panel

Compressor technology

Compressor cooling appliances work with a CFC-free refrigerant that changes from liquid to gas as it flows through the evaporator. In the process the evaporator extracts heat from the refrigeration compartment – it's getting cold. The compressor draws in the gaseous refrigerant, compresses it and passes it on to the condenser. Here, the absorbed heat is released to the atmosphere. The refrigerant changes to the original liquid state and flows back to the evaporator, where the cycle starts again.

- | Trouble-free operation with 12/24 volts or 12/24 volts and 100 – 240 volts AC
- | Refrigeration and deep-freezing
- | Excellent cooling performance even at extreme ambient temperatures
- | Minimal power consumption
- | Integrated battery protection
- | Ideal for solar operation

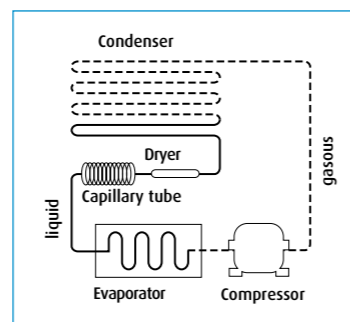

Super-compact compressor coolers

Favourably priced entry-level compressor coolers. With performance and handling qualities that will ensure you will enjoy their benefits for years to come. Refrigeration and deep freezing, 10.5 to 23 litre capacity. In addition, they feature a compact design which fits where others won't.

Fridge/freezer with rechargeable battery

Super-cool, even if there's no external power available, for up to 18 hours! The integrated battery can be recharged from the boat battery or a mains socket (optional mains adapter). With mains priority circuit and further comfort features.

WAECO CoolFreeze CDF

Pages 18 – 21

WAECO CoolFreeze CF

Page 27



CoolFreeze CDF-11

CoolFreeze CDF-18

CoolFreeze CDF-25

CoolFreeze CF-32UP

High-tech coolers

Unbeatable performance in all mobile applications. Excellent cooling and deep-freezing even at extreme ambient temperatures. Compact dimensions, energy-saving and quiet operation. Available in sizes from 31–106 litres, for 12/24 volts DC and 100–240 volts AC.

WAECO CoolFreeze CF

Pages 22 – 26



CoolFreeze CF-35

CoolFreeze CF-40

CoolFreeze CF-50

CoolFreeze CF-60



CoolFreeze CF-80

CoolFreeze CF-110



Ice-cold mobility!

Slimline compressor coolers at nice prices

The three coolers in the WAECO CoolFreeze CDF series like to travel as much as you do. And are as hassle-free to handle as a thermoelectric cooler. Its remarkably low weight, shoulder strap, and carry handle/s make it absolutely "portable" and ready to go anywhere. And stowage won't ever be a problem: the highly compact design means it will fill any niche perfectly. Additional plus points really start to add up when it comes to performance: refrigeration and deep-freezing up to -18°C with minimal energy consumption! And the pricing? So convincing that you won't be able to resist ...

The benefits of the WAECO CoolFreeze CDF at a glance:

- › **Excellent cooling and deep-freezing** even at extreme outside temperatures.
- › **Slim, slender design**
- › **Very comfortable to carry**
- › **Energy saving and superbly quiet operation**
- › **Impeccable operation in inclined position**
- › **12 / 24 volts DC**
- › **230-volt connection with low-priced mains adapter**
- › **Suitable for operation with a solar panel**

The compressor sensation

All the advantages now available in pocket-size format!

The WAECO CoolFreeze CDF-11, which is suitable for deep freezing, represents a new era in the world of compressor coolers. And that in a size which previously seemed impossible. As incredibly compact as a thermoelectric BordBar and therefore an optimum fit - in corners, cabinets and in towing vehicles - strapped in on the passenger or rear seat. 10.5 litre volume, refrigeration and deep freezing down to -18°C, regardless of high ambient temperatures. Only 8.8 kg in weight, and the shoulder strap makes it comfortable to carry.



WAECO CoolFreeze CDF-11

Portable compressor cooler for refrigeration and deep-freezing

4.29

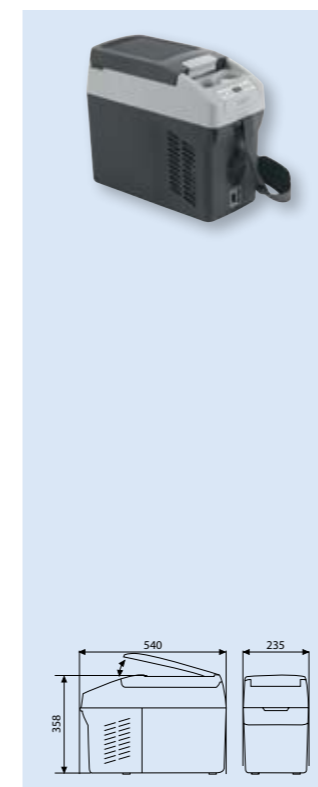

Gross capacity	approx. 10.5 litres
Voltage	12 / 24 volts DC
Power input	approx. 30 watts
Temperature range	+10°C to -18°C, continuously variable via electronic thermostat
Power consumption	0.36 kWh/24 h
Insulation	CFC-free polyurethane foam
System	Compressor with integrated control electronics, low voltage protection (can be disabled), electronic fuse/automatic reverse pole protection
Colour	Pale grey / dark grey
Weight	approx. 8.8 kg
Quality features	Electronic thermostat with digital temperature display, 3-stage battery monitor, LED interior light, adjustable shoulder strap, two drink holders, easy and secure fastening with the vehicle safety belt
Scope of delivery	DC connection cable
Test marks	CE, e-approved to 2006/28/EC (Automotive EMC Directive)

NEW



Temperature range
+10°C to -18°C



Suitable for solar operation

Extremely compact design

Two integrated drink holders

Securely fastened in a vehicle using the vehicle's own seat belts

230-volt connection with low-priced mains adapter (p. 62 - 65)

Product	Ref. No.
CoolFreeze CDF-11	9105100007
Optional extras: Mains adapter 230 V > 24 V	EPS-100W



Two practical drink holders, convenient access with one hand



Enough room for the day's provisions, extra compartment for small snacks



Display with digital temperature readout



Connection cable for 12 / 24 volts DC, battery monitor can be disabled

Compressor cooling "light"

Fridge and freezer all in one

Another "flyweight": the WAECO CoolFreeze CDF-18 is also remarkably light for a compressor cooler. At just 11.5 kg, it is extremely comfortable to transport using the sturdy carry handle. Thanks to optimised interior and exterior dimensions, the cooler provides a whopping 18 litre capacity and easily holds 2-litre bottles. An ideal size for the day's provisions while travelling. In terms of performance, the CDF-18 qualifies as a true heavy-weight: refrigeration and deep-freezing up to -18°C with minimal energy consumption!



The truly portable fridge/freezer

WAECO CoolFreeze CDF-18

Portable compressor cooler for refrigeration and deep-freezing

4.29



Gross capacity	approx. 18 litres
Voltage	12 / 24 volts DC
Power input	approx. 35 watts
Average running time	10% at +20°C ambient temperature 18% at +32°C ambient temperature both at +5°C interior temperature
Power consumption	Power input x average running time
Temperature range	+10°C to -18°C, continuously variable via electronic thermostat
Insulation	CFC-free PU foam
System	Compressor with integrated control electronics, low-voltage protection adjustable for leisure or starter battery by means of a slide switch, electronic fuse / automatic reverse pole protection, dynamically ventilated wire tube condenser, aluminium rollbond evaporator
Material	Cabinet: PP; lid: PE
Colour	Body: pale grey / dark grey; lid: dark grey
Weight	approx. 11.5 kg
Quality features	Detachable fold-up lid, sturdy carrying handle, vertical space for standing 2-litre bottles
Scope of delivery	DC connection cable
Test marks	CE, TÜV/GS, e-approved to 2006/28/EC (Automotive EMC Directive)

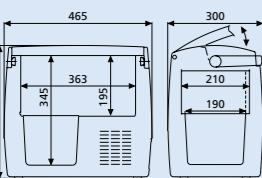

Product	Ref. No.
CoolFreeze CDF-18	9105100002
Optional extras	
Mains adapter 230 V ' 24 V	EPS-100W
Insulating protective cover	IC-CF-18



Temperature range
+10°C to -18°C



Suitable for
solar operation

Energy saver:
short running times with
reinforced insulation:
consumes only 0.29
Ah/h to reach +5°C
interior temperature
at +20°C ambient
temperature

Insulating protective
cover as accessory
(page 29)

230-volt connection with
low-priced mains adapter
(p. 62 - 65)



Easy to operate, secure closing mechanism



Robust, elegant, extremely comfortable carrying handle



Vertical insertion of the folding grid: space for standing 2-litre bottles



Salad underneath, bottles above: the horizontal folding grid arranges everything



Left: continuously variable electronic thermostat; right: two-stage battery monitor

Fits into every niche

Slim size, nice price

It fits where others won't: with its tall and slim design, the WAECO CoolFreeze CDF-25 effortlessly slides into narrow gaps and niches in your boat. It can be secured in place by a fixing kit - available as an optional extra. It is convenient to transport and provides 23 litres capacity for refrigeration or deep-freezing. Power consumption? Minimal. All in all, a cool insider tip for price-conscious buyers!



Extremely economical!

WAECO CoolFreeze CDF-25

Compressor cooler for refrigeration and deep-freezing

4.29



Gross capacity	approx. 23 litres (19 l for refrigeration / deep-freezing, 4 l for fresh food)
Voltage	12 / 24 volts DC
Power input	approx. 35 watts
Average running time	15% at +20°C ambient temperature 19% at +32°C ambient temperature both at +5°C interior temperature
Power consumption	Power input x average running time
Temperature range	+10°C to -18°C, continuously variable via electronic thermostat
Insulation	CFC-free PU foam
System	Compressor with integrated control electronics, low voltage protection adjustable for leisure and starter battery by means of a slide switch, electronic fuse / automatic reverse pole protection, dynamically ventilated wire tube condenser, aluminium rollbond evaporator
Material	Cabinet: PP; lid: PE
Colour	Body: pale grey / dark grey; lid: dark grey
Weight	approx. 12.5 kg
Quality features	Detachable lid (lid mount at the front), vertical space for standing 2-litre bottles, interior light
Scope of delivery	DC connection cable, detachable wire basket
Test marks	CE, TÜV/GS, e-approved to 2006/28/EC (Automotive EMC Directive)

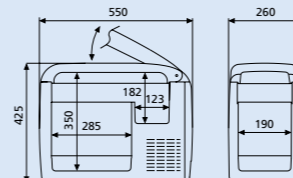

Product	Ref. No.
CoolFreeze CDF-25	9105100003
Optional extras	
Mains adapter 230 V ' 24 V	EPS-100W
Universal fixing kit	UFK-C
Insulating protective cover	IC-CF-25



Temperature range
+10°C to -18°C



Suitable for
solar operation

Slim body -
minimal space
consumption

Insulating protective
cover and fixing kit as
accessories
(pages 28 - 29)

230-volt connection with
low-priced mains adapter
(p. 62 - 65)



Closing mechanism: easy to use and super-safe



Left: continuously variable electronic thermostat; right: two-stage battery monitor



Robust lid hinge, sturdy injection moulded cabinet



Space for upright storage of 2-litre bottles across the entire base



Premium boxes for all applications

High-tech unlimited

Compressor technology at its best – that’s the term used to describe the **CoolFreeze series coolers CF-35 to CF-110**. **The high-performance appliances can be operated on almost any mains network.** Whether 12, 24, 100 or 240 volts – the integrated power supply unit recognises each voltage and adjusts itself accordingly.

CoolFreeze CF series coolers feature optimised dimensions and are easy to transport. Their generous capacity makes them ideal for use on boats and yachts, in motorhomes or caravans – wherever mobile refrigeration is required.

Optional accessories include **fridge slides** for convenient slide-out access and a **fixing kit** for a firm and secure hold in the vehicle.

CoolFreeze CF-35 to CF-110 – the significant benefits at a glance:

- › **CF special electronics with digital temperature display**
- › **12 / 24 volts DC and 100 – 240 volts AC**
- › **Excellent cooling performance** even at extreme ambient temperatures
- › **Deep-freeze functionality**
- › **Energy saving and superbly quiet operation**
- › **Impeccable operation in inclined position**
- › **Suitable for operation with a solar panel**

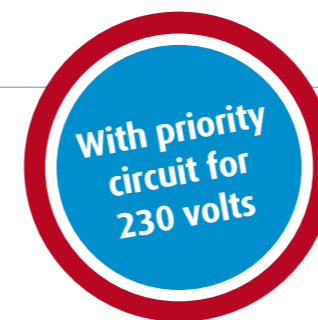

CoolFreeze CF-35 CoolFreeze CF-40 CoolFreeze CF-50 **NEW!** CoolFreeze CF-60 CoolFreeze CF-80 CoolFreeze CF-110

CF special electronics with digital temperature display, soft start and turbo cooler

The six CoolFreeze models CF-35 to CF-110 are all equipped with CF special electronics. Their functions:

- › **Intelligent, automatic turbo cooler**
- › **3-stage battery protection, set using the digital display**
- › **4-digit display**
- › **Display readout in Celsius or Fahrenheit**
- › **Free temperature setting on the display**
- › **Display of current interior temperature**
- › **Status and error indication by 2 separate LEDs**
- › **Memory function saves the last settings**



Turbo power with economy. The CF special electronics system gives the compressor a soft and power-saving start at 2500 rpm. If the preset temperature below -12°C has not been reached within a short period of time or a temperature below -12°C has been set, the turbo cooler switches on automatically to boost the compressor speed. As soon as a preset temperature up to -12°C has been reached, the system switches back to economy mode (except if a temperature below -12°C has been set).

The outcome: fast yet economical cooling from +10°C to -18°C.



Standard interior light for a clear overview in the dark



Ready for connection to 12 / 24 volts DC and 100 – 240 volts AC with mains priority circuit



A smart organiser: detachable wire basket (all models except CF-35); CF-40 / CF-50: wire basket with grid divider



Convenient transport with ergonomically shaped recessed grips and sturdy, detachable handles

› **Slides, universal fixing kit, insulation and protective covers available as accessories (p. 28 / 29)**

WAECO CoolFreeze CF-35

Compressor cooler for refrigeration and deep-freezing with CF special electronics

4.10



Gross capacity	approx. 31 litres (26.5 l for refrigeration / deep-freezing, 4.5 l for fresh food)
Voltage	12 / 24 volts DC and 100 – 240 volts AC
Power consumption	approx. 45 watts
Average running time	15% at +20°C ambient temperature 19% at +32°C ambient temperature both at +5°C interior temperature
Power consumption	Power input x average running time
Temperature range	+10°C to -18°C, free temperature setting via electronic thermostat with digital temperature readout
Insulation	CFC-free PU foam
System	Fully hermetic Danfoss BD35F compressor with integrated control electronics, low voltage protection adjustable for leisure and starter battery via electronic system, electronic fuse / automatic reverse pole protection, dynamically ventilated wire tube condenser, aluminium rollbond evaporator
Material	Cabinet: PP, lid: PE
Colour	Body: pale grey / dark grey; lid: dark grey
Weight	approx. 15 kg
Quality features	Detachable lid (lid mount at the front), interior light, vertical space for standing 1.5-litre bottles. CF special electronics with soft start and turbo cooler (p. 23)
Scope of delivery	DC and AC connection cables, evaporator grille, detachable carrying handles
Test marks	CE, TÜV/GS, e-approved to 2006/28/EC (Automotive EMC Directive)

Product	Ref. No.
CoolFreeze CF-35	CF-035AC
Optional extras	
Fridge slide, long	SLD-060
Fridge slide, wide	SLD-060W
Universal fixing kit	UFK-C
Insulating protective cover	IC-CF-35

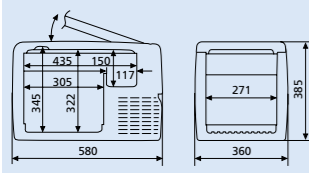

WAECO CoolFreeze CF-40

Compressor cooler for refrigeration and deep-freezing with CF special electronics



Gross capacity	approx. 37 litres (31 l for refrigeration / deep-freezing, 6 l for fresh food)
Voltage	12 / 24 volts DC and 100 – 240 volts AC
Power input	approx. 45 watts
Average running time	18% at +20°C ambient temperature 22% at +32°C ambient temperature both at +5°C interior temperature
Power consumption	Power input x average running time
Temperature range	+10°C to -18°C, free temperature setting via electronic thermostat with digital temperature readout
Insulation	CFC-free PU foam
System	As for CF-35
Material	Cabinet: PP, lid: PE
Colour	Body: pale grey / dark grey; lid: dark grey
Weight	approx. 16 kg
Quality features	Detachable lid (lid mount at the front), interior light, vertical space for standing 2-litre bottles. CF special electronics with soft start and turbo cooler (p. 23)
Scope of delivery	DC and AC connection cables, removable wire basket, detachable carrying handles
Test marks	CE, TÜV/GS, e-approved to 2006/28/EC (Automotive EMC Directive)

Product	Ref. No.
CoolFreeze CF-40	CF-040AC
Optional extras	
Fridge slide, long	SLD-060
Fridge slide, wide	SLD-060W
Universal fixing kit	UFK-C
Insulating protective cover	IC-CF-40

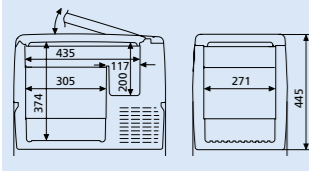

Protective cover, fridge slides and fixing kit as accessories (pages 28 – 29)

CF special electronics with soft start and turbo cooler



WAECO CoolFreeze CF-50

Compressor cooler for refrigeration and deep-freezing with CF special electronics



Gross capacity	approx. 49 litres (41 l for refrigeration/deep-freezing, 8 l for fresh food)
Voltage	12 / 24 volts DC and 110 – 240 volts AC
Power input	approx. 45 watts
Average running time	15% at +20°C ambient temperature 19% at +32°C ambient temperature both at +5°C interior temperature
Power consumption	Power input x average running time
Temperature range	+10°C to -18°C, free temperature setting via electronic thermostat with digital temperature readout
Insulation	CFC-free PU foam
System	As for CF-35
Material	Cabinet: PP, lid: PE
Colour	Body: pale grey / dark grey; lid: dark grey
Weight	approx. 18 kg
Quality features	Detachable lid (plug-in lid mount, variable left/right), interior light, vertical space for standing 2-litre bottles. CF special electronics with soft start and turbo cooler (p. 23)
Scope of delivery	As for CF-40
Test marks	CE, TÜV/GS, e-approved to 2006/28/EC (Automotive EMC Directive)

Product	Ref. No.
CoolFreeze CF-50	CF-050AC
Optional extras	
Fridge slide, long	SLD-060
Fridge slide, wide	SLD-060W
Universal fixing kit	UFK-C
Insulating protective cover	IC-CF-50

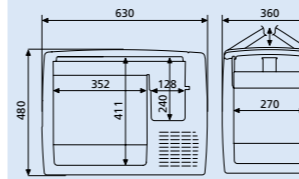

Protective cover, fridge slides and fixing kit as accessories (pages 28 – 29)

CF-50 / CF-60: Detachable lid, folds up transversely, variable lid mounts

WAECO CoolFreeze CF-60

Compressor cooler for refrigeration and deep-freezing with CF special electronics



Gross capacity	approx. 59 litres (51 l for refrigeration/deep-freezing, 8 l for fresh food)
Voltage	12 / 24 volts DC and 100 – 240 volts AC
Power input	approx. 45 watts
Average running time	18% at +20°C ambient temperature, 22% at +32°C ambient temperature, both at +5°C interior temperature
Power consumption	Power input x average running time
Temperature range	+10°C to -18°C, free temperature setting via electronic thermostat with digital temperature readout
Insulation	CFC-free polyurethane foam
System	see CF-35
Material	Cabinet: PP; lid: PE
Colour	Body: pale grey / dark grey; lid: dark grey
Weight	approx. 21.6 kg
Quality features	Detachable lid (plug-in lid mount, variable left / right), interior light, vertical space for 2-litre bottles, CF special electronics with soft start and turbo cooler (p. 23)
Scope of delivery	DC and AC connection cables, removable wire basket, detachable carrying handles
Test marks	CE, TÜV/GS, e-approved to 2006/28/EC (Automotive EMC Directive)

Product	Ref. No.
CoolFreeze CF-60	CF-060AC
Optional extras	
Fridge slide, long	SLD-060
Fridge slide, wide	SLD-060W
Universal fixing kit	UFK-C
Insulating protective cover	IC-CF-60

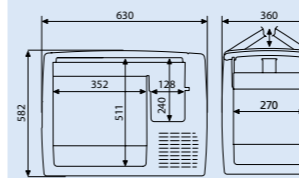

CF special electronics with soft start and turbo cooler



WAECO CoolFreeze CF-80

Large-capacity cooler for refrigeration and deep-freezing with CF special electronics

4.10



Gross capacity	approx. 80 litres (73 l for refrigeration / deep-freezing, 7 l for fresh food)
Voltage	12 / 24 volts DC and 100 – 240 volts AC
Power input	approx. 65 watts
Average running time	12% at +20°C ambient temperature 22% at +32°C ambient temperature both at +5°C interior temperature
Power consumption	Power input x average running time
Temperature range	+10°C to -18°C, free temperature setting via electronic thermostat with digital temperature readout
Insulation	CFC-free PU foam
System	Fully hermetic Danfoss BD50F compressor with integrated control electronics, low voltage protection adjustable for leisure and starter battery via electronic system, electronic fuse/ automatic reverse pole protection, dynamically ventilated fin condenser, aluminium rollbond evaporator
Material	Cabinet: coated sheet steel, top and base: PP, lid: PE
Colour	Body: pale grey / dark grey, lid: pale grey
Weight	approx. 31 kg
Quality features	Detachable lid (screw-on lid mount, variable left / right), sturdy latches and hinges, interior light, vertical space for 2-litre bottles. CF special electronics with soft start and turbo cooler (p. 23)
Scope of delivery	DC and AC connection cables, removable wire basket, detachable carrying handles
Test marks	CE, TÜV/GS, e-approved to 2006/28/EC (Automotive EMC Directive)

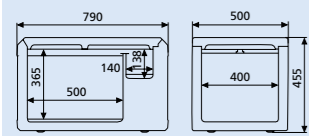

WAECO CoolFreeze CF-110

Large-capacity cooler for refrigeration and deep-freezing with CF special electronics



Gross capacity	approx. 106 litres (93 l for refrigeration / deep-freezing, 13 l for fresh food)
Voltage	12 / 24 volts DC and 100 – 240 volts AC
Power input	approx. 65 watts
Average running time	14% at +20°C ambient temperature 25% at +32°C ambient temperature both at +5°C interior temperature
Power consumption	Power input x average running time
Temperature range	+10°C to -18°C, free temperature setting via electronic thermostat with digital temperature readout
Insulation	CFC-free PU foam
System	As for CF-80
Material	Cabinet: coated sheet steel, top and base: PP, lid: PE
Colour	Body: pale grey / dark grey, lid: pale grey
Weight	approx. 33 kg
Quality features	Detachable lid (screw-on lid mount, variable left / right), sturdy latches and hinges, interior light, vertical space for 2-litre bottles. CF special electronics with soft start and turbo cooler (p. 23)
Scope of delivery	DC and AC connection cables, removable wire basket, detachable carrying handles
Test marks	CE, TÜV/GS, e-approved to 2006/28/EC (Automotive EMC Directive)

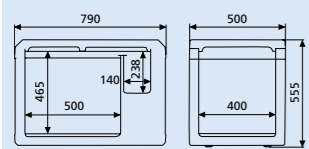

Product	Ref. No.
CoolFreeze CF-110	CF-110AC
Optional extras: Fridge slide, long	SLD-110
Fridge slide, wide	SLD-110W
Insulating protective cover	IC-CF-110



Temperature range
+10°C to -18°C



Suitable for
solar operation



12 / 24 volts DC and
100 – 240 volts AC

**Jumbo coolers
for personal and
professional use**

**Fridge slides and
protective covers
as accessories
(pages 28 – 29)**

**CF special electronics
with soft start and
turbo cooler**



Truly independent

Integrated battery-run fridge / freezer

Tried-and-tested on Australia's most beautiful and loneliest beaches – and now available here: the CoolFreeze CF-32UP provides refrigeration and deep-freezing up to -18°C. And that's for up to 18 hours without an external power supply!

When ashore, the power required is delivered by the **integrated battery** in the compressor cooler. It is charged from the 12- or 24-volt boat battery or the mains before use and simply switched on when necessary. The matching mains adapter comes as a separate accessory.



WAECO CoolFreeze CF-32UP

Compressor cooler / freezer with rechargeable battery

4.10



Gross capacity	approx. 31 litres
Voltage	12 / 24 volts DC
Power input	approx. 45 watts (cooling only) approx. 72 watts (cooling and charging)
Charging time	12 to 15 hours
Operation with battery	Up to 18 hours with fully charged battery at +5°C interior and +32°C ambient temperature
Average running time	18% at +20°C ambient temperature 22% at +32°C ambient temperature both at +5°C interior temperature
Power consumption	Power input x average running time
Temperature range	+10°C to -18°C, continuously variable via electronic thermostat with digital temperature display
Insulation	CFC-free PU foam
System	Fully hermetic Danfoss BD35F compressor with integrated control electronics, low-voltage protection, electronic fuse / automatic reverse pole protection, dynamically ventilated wire tube condenser, aluminium rollbond evaporator
Material	Cabinet: PP; lid: PE
Colour	Body: pale grey / dark grey, lid: dark grey
Weight	approx. 24 kg
Quality features	Intelligent battery monitor to prevent excessive discharging of the vehicle battery, display with digital temperature readout, temperature adjustable with two buttons in 1°C steps, simultaneous charging and cooling, battery charging state indicated by LED, battery low warning
Scope of delivery	DC connection cable, wire basket, attachable carrying handles
Test marks	CE, TÜV/GS, E-approved according to UN-ECE R10 directive

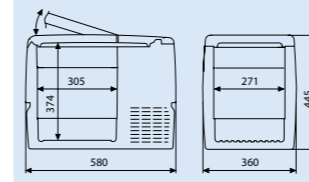

Product	Ref. No.
CoolFreeze CF-32UP	9105100001
Optional extras: Mains adapter 110 – 240 V / 24 V	MPS-50
Fridge slide, long	SLD-060
Fridge slide, wide	SLD-060W
Universal fixing kit	UFK-C



Temperature range
+10°C to -18°C



Suitable for
solar operation

**With integrated battery
for up to 18 hours
operation
without external power**

**Fridge slides and
fixing kit as
accessories
(page 28)**

**230-volt connection with
low-priced mains adapter
(p. 62 – 65)**



**An extra control panel
for the battery:
ON/OFF switch, LED dis-
play showing the battery
charging state**

Fridge slides, long and wide version

For CoolFreeze CF-32UP / CF-35 / CF-40 / CF-50 / CF-60

For fastening of WAECO CoolFreeze coolers in vehicles and for convenient loading and unloading

4.10



Material / Colour	Powder coated metal / grey
Weight	11.5 kg
Dimensions (W x H x D) mm	SLD-060
	Retracted: 421 x 85.4 x 760 Extended: 421 x 85.4 x 1418
	SLD-060W
	Retracted: 789 x 85.3 x 475 Extended: 789 x 85.3 x 938
Quality features	50 kg max. load capability, tie-down straps included in the set
Product Ref. No.	
Fridge slide, long for CF-32UP / CF-35 / 40 / 50 / 60	SLD-060
Fridge slide, wide for CF-32UP / CF-35 / 40 / 50 / 60	SLD-060W

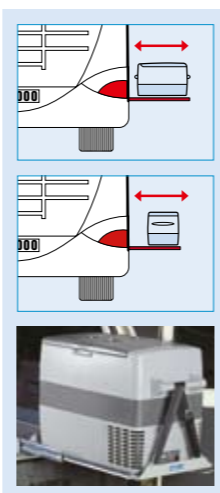

Fridge slides, long and wide version

For CoolFreeze CF-80 / CF-110

For fastening of WAECO CoolFreeze coolers in vehicles and for convenient loading and unloading

4.10



Material/Colour	Powder coated metal / grey
Weight	19.4 kg
Dimensions (W x H x D) mm	SLD-110
	Retracted: 574 x 85.4 x 909 Extended: 574 x 85.4 x 1677
	SLD-110W
	Retracted: 939 x 85.3 x 690 Extended: 939 x 85.3 x 1368
Quality features	100 kg max load capability, tie-down straps included in the set
Product Ref. No.	
Fridge slide, long for CF-80 / 110	SLD-110
Fridge slide, wide for CF-80 / 110	SLD-110W

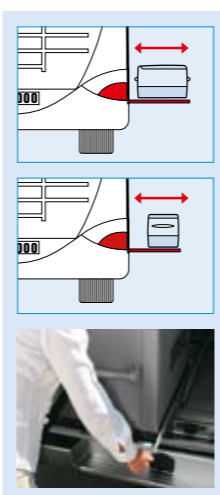

Universal fixing kit

For CoolFreeze CDF-25 / CF-32UP / CF-35 / CF-40 / CF-50 / CF-60

For fastening of WAECO CoolFreeze coolers in vehicles

4.10

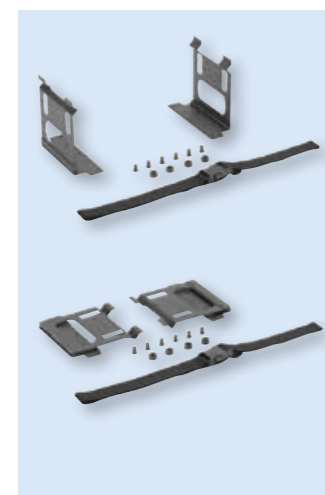

Material	Powder-coated metal
Colour	Black
Scope of delivery	Two frame sections, adjustable strap with snap lock, set of screws
Product Ref. No.	
Universal fixing kit	UFK-C



Protective covers for CoolFreeze coolers

The functional all-round protection for your coolers

Does the zest for outdoor adventure take you over rough terrain at times? Go ahead, the **insulating protective cover** makes your CoolFreeze cooler fit for tough challenges. The cover protects the valuable appliance from moisture, dust and dirt. It also provides effective insulation, improving the unit's cooling capacity by a full 2°C – at the same energy consumption. The robust and functional all-round protection is available for CoolFreeze models CDF-18 / 25 and CF-35 to CF-110.



Insulating protective covers

For CoolFreeze CDF-18 / CDF-25 / CF-35 / CF-40 / CF-50 / CF-60 / CF-80 / CF-110

4.10

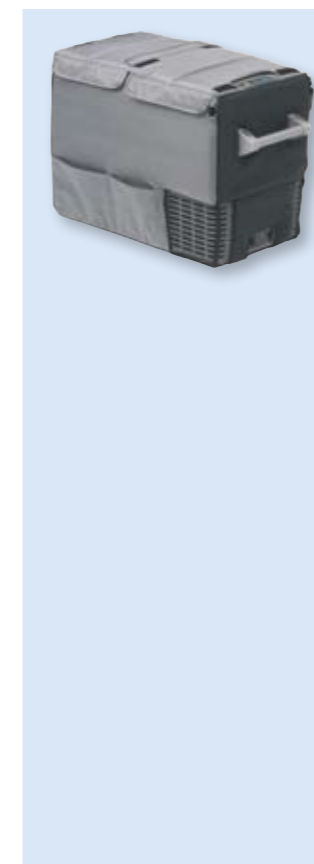

Material, outside	High-quality silver-grey Oxford nylon, lid and base in robust, rubber coated, black nylon
Material, inside	Aluminium coated polyester
Colour, sides	Silver grey
Colour, lid and base	Black
Quality features	Detachable lid and base, outside pockets to store small items, four fixing rings to secure the box safely in the vehicle

Extra protection and insulation for your cooler

Product	Weight (kg)	Ref. No.
Protective cover for CoolFreeze CDF-18	approx. 1.0	IC-CF-18
Protective cover for CoolFreeze CDF-25	approx. 1.1	IC-CF-25
Protective cover for CoolFreeze CF-35	approx. 1.3	IC-CF-35
Protective cover for CoolFreeze CF-40	approx. 1.5	IC-CF-40
Protective cover for CoolFreeze CF-50	approx. 2.0	IC-CF-50
Protective cover for CoolFreeze CF-60	approx. 2.0	IC-CF-60
Protective cover for CoolFreeze CF-80	approx. 2.2	IC-CF-80
Protective cover for CoolFreeze CF-110	approx. 2.4	IC-CF-110



Direct access to the controls ...



... and connection sockets



Practical outside pockets for small items



Top insulation in aluminium coated polyester